

# HUNDRED

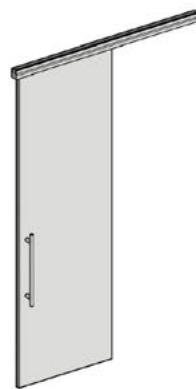
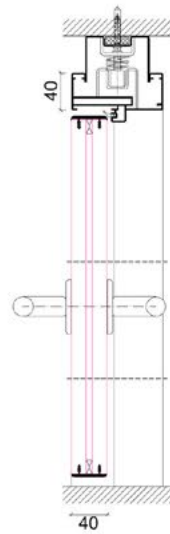
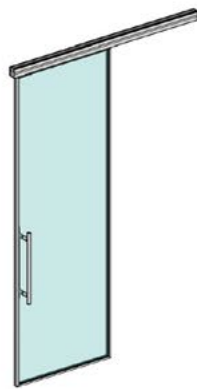
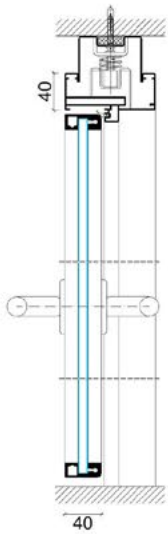
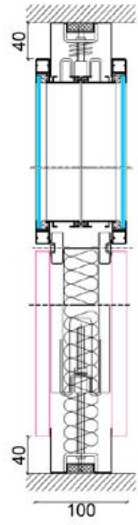
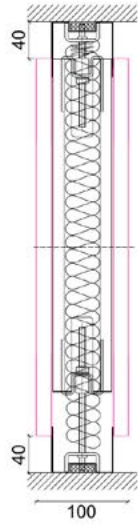
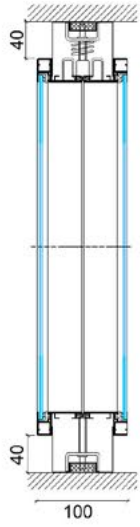

## Caratteristiche tecniche - Technical features

### PANNELLI

Spessore 100 mm

- Doppio vetro temperato 4 mm con assorbimento acustico di 35 dB
- Doppio pannello melaminico 19 mm con assorbimento acustico di 36 dB con inserimento di lana di roccia

### PANELLING

Thickness 100 mm

- Double 4 mm tempered glazing with 35 dB sound absorption
- Double melamine panel 19 mm with 36 dB sound absorption with mineral wool insertion

### PORTE

Spessore 40 mm

- Vetro temperato 10 mm
- Doppio pannello melaminico 19 mm

### DOORS

Thickness 40 mm

- 10 mm tempered glazing
- Double melamine panel 19 mm

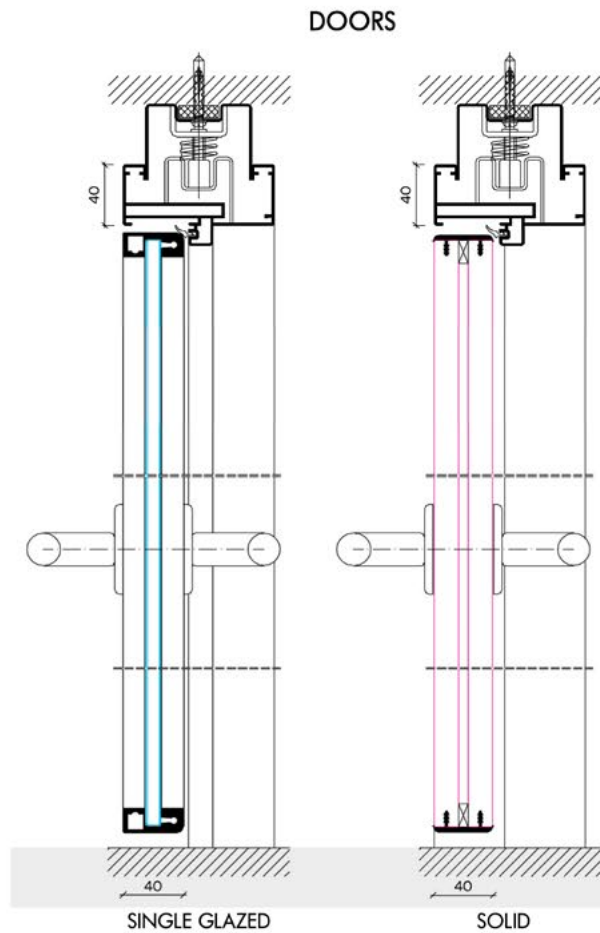
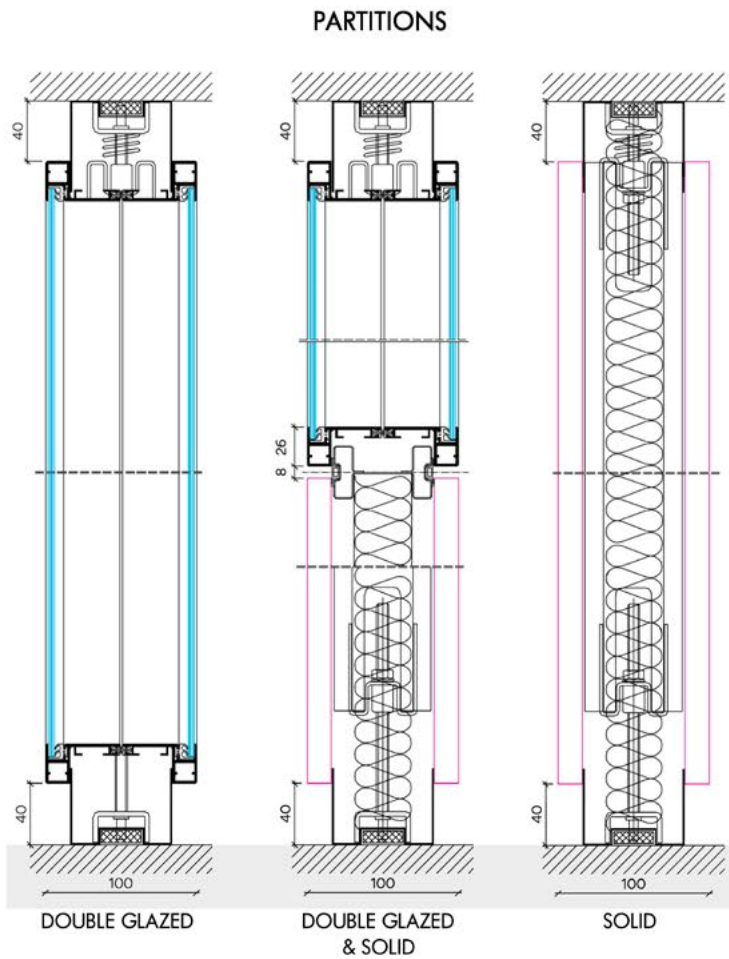

---

## HUNDRED - Parete divisoria - Partition wall

---



Modulo di parete divisoria vetrata con spessore 10 cm e altezza variabile da 240 a 320 cm. Doppio vetro temperato 4 mm trasparente o sabbciato. Profili in alluminio anodizzato naturale o verniciati bianchi (RAL 9010) o neri (RAL 9005).

10 cm thick glazed partition wall module with variable height from 240 to 320 cm. Double tempered glazing 4 mm clear or sandblasted. Profiles in natural anodized aluminum or painted white (RAL 9010) or black (RAL 9005).

Code
------

ZYHUNDREDDIV1000
------------------

Vetro trasparente - Clear glass
---------------------------------

ZYHUNDREDDIV1001
------------------

Vetro sabbciato - Sandblasted glass
-------------------------------------



Modulo di parete divisoria cieca con spessore 10 cm e altezza variabile da 240 a 320 cm. Doppio pannello melaminico. Profili in alluminio anodizzato naturale o verniciati bianchi (RAL 9010) o neri (RAL 9005).

10 cm thick solid partition wall module with variable height from 240 to 320 cm. Double melamine coated panel. Profiles in natural anodized aluminum or painted white (RAL 9010) or black (RAL 9005).

Code
------

ZYHUNDREDDIV1002
------------------

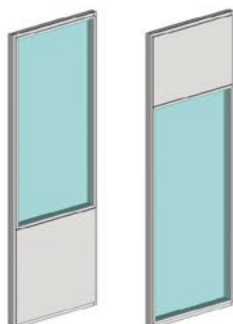

Modulo di parete divisoria combinata vetro-cieca con spessore 10 cm e altezza variabile da 240 a 320 cm. Doppio vetro temperato 4 mm trasparente o sabbciato con porzione di 1/3 superiore o inferiore in doppio pannello melaminico. Profili in alluminio anodizzato naturale o verniciati bianchi (RAL 9010) o neri (RAL 9005).

10 cm thick partition wall module combined glazed and solid with variable height from 240 to 320 cm. Double tempered glazing 4 mm clear or sandblasted with 1/3 upper or lower portion in double melamine coated panel. Profiles in natural anodized aluminum or painted white (RAL 9010) or black (RAL 9005).

Code
------

ZYHUNDREDDIV1003
------------------

Vetro trasparente - Clear glass
---------------------------------

ZYHUNDREDDIV1004
------------------

Vetro sabbciato - Sandblasted glass
-------------------------------------



Modulo di parete divisoria combinata vetro-cieca con spessore 10 cm e altezza variabile da 240 a 320 cm. Doppio pannello melaminico con porzione superiore di 1/3 in doppio vetro temperato 4mm trasparente o sabbciato. Profili in alluminio anodizzato naturale o verniciati bianchi (RAL 9010) o neri (RAL 9005).

10 cm thick partition wall module combined glazed and solid with variable height from 240 to 320 cm. Double melamine coated panel with 1/3 upper portion in double tempered glazing 4 mm clear or sandblasted. Profiles in natural anodized aluminum or painted white (RAL 9010) or black (RAL 9005).

Code
------

ZYHUNDREDDIV1005
------------------

Vetro trasparente - Clear glass
---------------------------------

ZYHUNDREDDIV1006
------------------

Vetro sabbciato - Sandblasted glass
-------------------------------------

---

---

## HUNDRED - Parete divisoria - Partition wall

---



Modulo porta vetrata a battente intelaiata con spessore 4 cm larghezza 90 cm e altezza variabile da 220 a 270 cm. Vetro temperato 10 mm trasparente o sabbciato. Profili in alluminio anodizzato naturale o verniciati bianchi (RAL 9010) o neri (RAL 9005). Maniglia inclusa.

Hinged glazed framed door module with a thickness of 4 cm, width 90 cm and variable height from 220 to 270 cm. 10 mm tempered glazing, clear or sandblasted. Profiles in natural anodized aluminum or painted white (RAL 9010) or black (RAL 9005). Handle included.

**Code**

**ZYHUNDREDDIV1010**

Vetro trasparente - Clear glass

**ZYHUNDREDDIV1011**

Vetro sabbciato - Sandblasted glass



Modulo porta cieca a battente intelaiata con spessore 4 cm larghezza 90 cm e altezza variabile da 220 a 270 cm. Doppio pannello melaminico. Profili in alluminio anodizzato naturale o verniciati bianchi (RAL 9010) o neri (RAL 9005). Maniglia inclusa.

Hinged framed solid door module with a thickness of 4 cm, width 90 cm and variable height from 220 to 270 cm. Double melamine coated panel. Profiles in natural anodized aluminum or painted white (RAL 9010) or black (RAL 9005). Handle included.

**Code**

**ZYHUNDREDDIV1012**

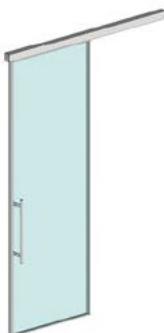

Modulo porta vetrata scorrevole intelaiata con spessore 4 cm larghezza 90 cm e altezza variabile da 220 a 270 cm. Vetro temperato 10 mm trasparente o sabbciato. Profili in alluminio anodizzato naturale o verniciati bianchi (RAL 9010) o neri (RAL 9005). Maniglia h. 60 cm inclusa.

Framed glazed sliding door module with a thickness of 4 cm, width 90 cm and variable height from 220 to 270 cm. 10 mm tempered glazing, clear or sandblasted. Profiles in natural anodized aluminum or painted white (RAL 9010) or black (RAL 9005). Handle h. 60 cm included.

**Code**

**ZYHUNDREDDIV1013**

Vetro trasparente - Clear glass

**ZYHUNDREDDIV1014**

Vetro sabbciato - Sandblasted glass

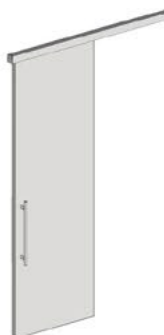

Modulo porta cieca scorrevole intelaiata con spessore 4 cm larghezza 90 cm e altezza variabile da 220 a 270 cm. Doppio pannello melaminico. Profili in alluminio anodizzato naturale o verniciati bianchi (RAL 9010) o neri (RAL 9005). Maniglia h. 60 cm inclusa.

Framed solid sliding door module with a thickness of 4 cm, width 90 cm and variable height from 220 to 270 cm. Double melamine coated panel. Profiles in natural anodized aluminum or painted white (RAL 9010) or black (RAL 9005). Handle h. 60 cm included.

**Code**

**ZYHUNDREDDIV1015**

# EIGHTY

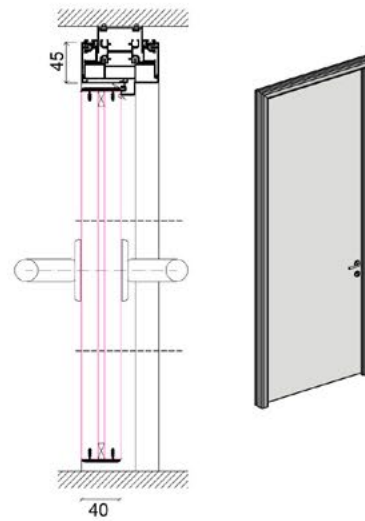
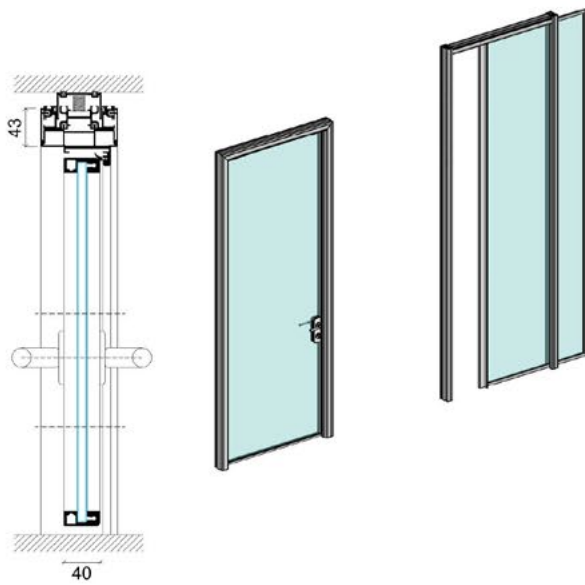
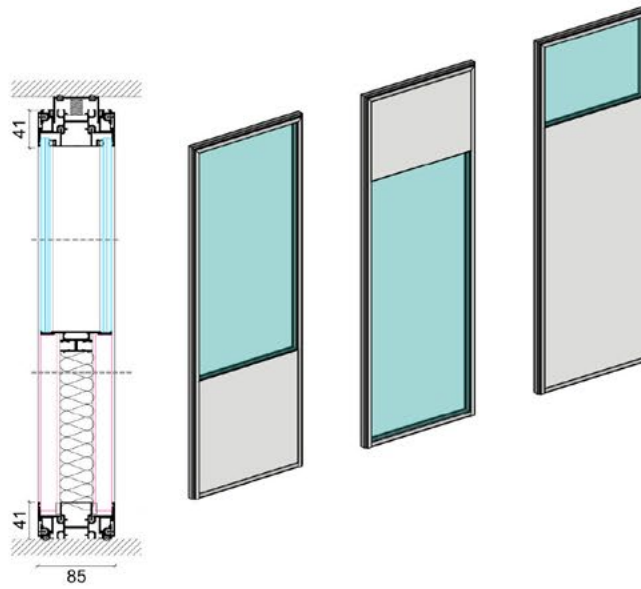
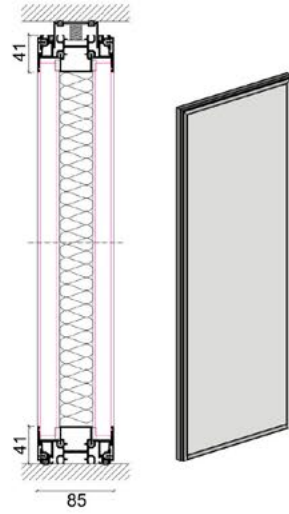
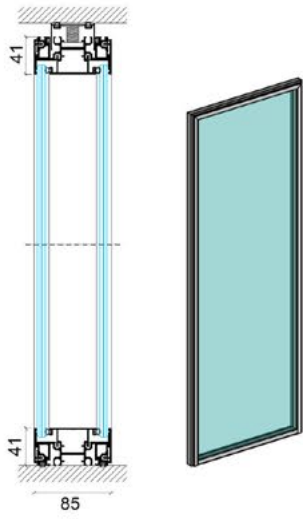

## Caratteristiche tecniche - Technical features

### PANNELLI

Spessore 85 mm

- Doppio vetro laminato 5+5 mm con interposto film di PVB 0,38 mm. Assorbimento acustico di 40 dB.
- Doppio vetro laminato 5+5 mm con interposto film di PVB 0,50 mm. Assorbimento acustico di 43 dB.
- Doppio pannello melaminico 19 mm con assorbimento acustico di 41 dB con inserimento di lana di roccia.

### PANELLING

Thickness 85 mm

- Double laminated glazing 5+5 mm with 0,38 mm PVB absorbing film interposed. 40 dB sound absorption.
- Double laminated glazing 5+5 mm with 0,50 mm PVB absorbing film interposed. 43 dB sound absorption.
- Double melamine panel 19 mm with 41 dB sound absorption with mineral wool insertion.

### PORTE

Spessore 40 mm

- Vetro temperato 10 mm per la porta a battente; vetro laminato 5+5 con interposto film PVB da 0,38 mm per la porta scorrevole.
- Doppio pannello melaminico 19 mm.

### DOORS

Thickness 40 mm

- 10 mm tempered glazing for the hinged door; 5+5 mm laminated glazing with 0.38 mm PVB absorbing film interposed for the sliding door.
- Double melamine panel 19 mm.

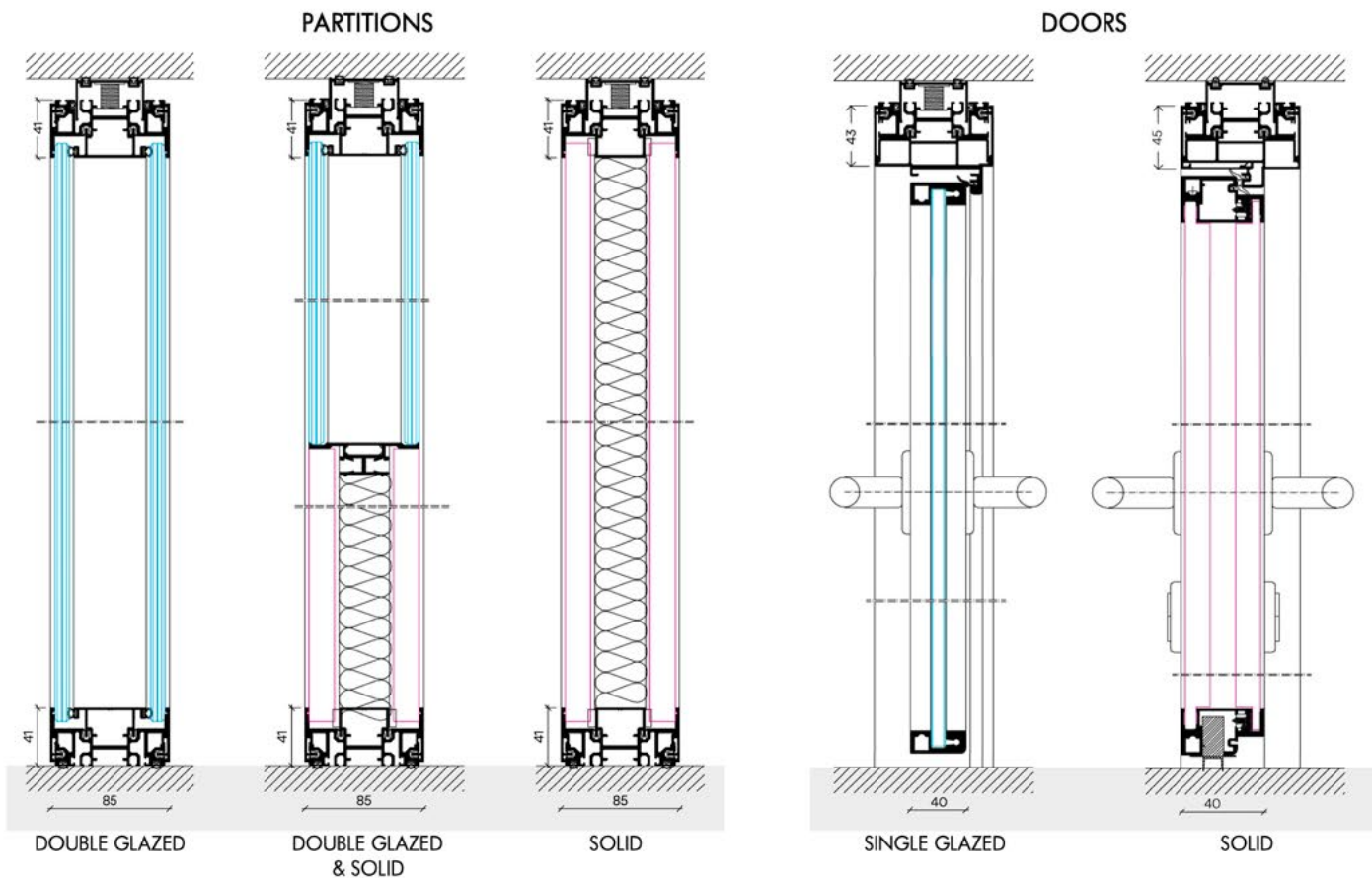

---

## EIGHTY - Parete divisoria - Partition wall

---

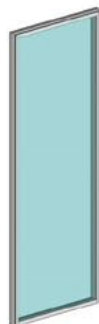

Modulo di parete divisoria vetrata con spessore 8,5 cm e altezza variabile da 240 a 320 cm. Doppio vetro laminato 5+PVB+5 mm trasparente o sabbato. Profili in alluminio anodizzato naturale o verniciati bianchi (RAL 9010) o neri (RAL 9005). Disponibile anche con doppio vetro supersilenziato trasparente con lamina di PVB da 0,5 mm.

8,5 cm thick glazed partition wall module with variable height from 240 to 320 cm. Double laminated glazing 5+PVB+5 mm clear or sandblasted. Profiles in natural anodized aluminum or painted white (RAL 9010) or black (RAL 9005). Also available with clear super-silenced laminated double glazed with 0.5 mm PVB sheet.

---

**Code**

---

**ZYEIGHTYDIV2000**

---

Vetro trasparente - Clear glass

**ZYEIGHTYDIV2001**

---

Vetro sabbato - Sandblasted glass

**ZYEIGHTYDIV2002**

---

Vetro trasparente supersilenziato - Clear super-silenced glass



Modulo di parete divisoria cieca con spessore 8,5 cm e altezza variabile da 240 a 320 cm. Doppio pannello melaminico. Profili in alluminio anodizzato naturale o verniciati bianchi (RAL 9010) o neri (RAL 9005).

8,5 cm thick solid partition wall module with variable height from 240 to 320 cm. Double melamine coated panel. Profiles in natural anodized aluminum or painted white (RAL 9010) or black (RAL 9005).

---

**Code**

---

**ZYEIGHTYDIV2003**

---

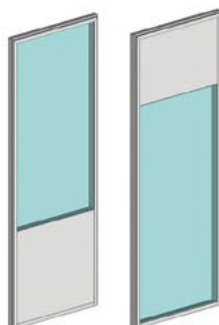

Modulo di parete divisoria combinata vetro-cieca con spessore 8,5 cm e altezza variabile da 240 a 320 cm. Doppio vetro laminato 5+PVB+5 mm trasparente o sabbato con porzione di 1/3 superiore o inferiore in doppio pannello melaminico. Profili in alluminio anodizzato naturale o verniciati bianchi (RAL 9010) o neri (RAL 9005). Disponibile anche con doppio vetro supersilenziato trasparente con lamina di PVB da 0,5 mm.

8,5 cm thick partition wall module combined glazed and solid with variable height from 240 to 320 cm. Double laminated glazing 5+PVB+5 mm clear or sandblasted with 1/3 upper or lower portion in double melamine coated panel. Profiles in natural anodized aluminum or painted white (RAL 9010) or black (RAL 9005). Also available with clear super-silenced laminated double glazed with 0.5 mm PVB sheet.

---

**Code**

---

**ZYEIGHTYDIV2004**

---

Vetro trasparente - Clear glass

**ZYEIGHTYDIV2005**

---

Vetro sabbato - Sandblasted glass

**ZYEIGHTYDIV2006**

---

Vetro trasparente supersilenziato - Clear super-silenced glass

---

## EIGHTY - Parete divisoria - Partition wall

---



Modulo di parete divisoria combinata vetro-cieca con spessore 8,5 cm e altezza variabile da 240 a 320 cm. Doppio pannello melaminico con porzione superiore di 1/3 in doppio vetro laminato 5+PVB+5 mm trasparente o sabbato. Profili in alluminio anodizzato naturale o verniciati bianchi (RAL 9010) o neri (RAL 9005). Disponibile anche con doppio vetro supersilenziato trasparente con lamina di PVB da 0,5 mm.

8,5 cm thick partition wall module combined glazed and solid with variable height from 240 to 320 cm. Double melamine coated panel with 1/3 upper portion in double laminated glazing 5+PVB+5 mm clear or sandblasted. Profiles in natural anodized aluminum or painted white (RAL 9010) or black (RAL 9005). Also available with clear super-silenced laminated double glazed with 0.5 mm PVB sheet.

---

**Code**

---

**ZYEIGHTYDIV2007**

---

Vetro trasparente - Clear glass

**ZYEIGHTYDIV2008**

---

Vetro sabbato - Sandblasted glass

**ZYEIGHTYDIV2009**

---

Vetro trasparente supersilenziato - Clear super-silenced glass

---



Modulo porta a battente vetrata intelaiata con spessore 4 cm larghezza 90 cm e altezza variabile da 220 a 270 cm. Vetro temperato 10 mm trasparente o sabbato. Profili in alluminio anodizzato naturale o verniciati bianchi (RAL 9010) o neri (RAL 9005). Maniglia inclusa.

Hinged framed glazed door module with a thickness of 4 cm, width 90 cm and variable height from 220 to 270 cm. 10 mm tempered glazing, clear or sandblasted. Profiles in natural anodized aluminum or painted white (RAL 9010) or black (RAL 9005). Handle included.

---

**Code**

---

**ZYEIGHTYDIV2020**

---

Vetro trasparente - Clear glass

**ZYEIGHTYDIV2021**

---

Vetro sabbato - Sandblasted glass

---



Modulo porta a battente cieca intelaiata con spessore 4 cm larghezza 90 cm e altezza variabile da 220 a 270 cm. Doppio pannello melaminico. Profili in alluminio anodizzato naturale o verniciati bianchi (RAL 9010) o neri (RAL 9005). Maniglia inclusa.

Hinged framed solid door module with a thickness of 4 cm, width 90 cm and variable height from 220 to 270 cm. Double melamine coated panel. Profiles in natural anodized aluminum or painted white (RAL 9010) or black (RAL 9005). Handle included.

---

**Code**

---

**ZYEIGHTYDIV2022**

---



---

## EIGHTY - Parete divisoria - Partition wall

---

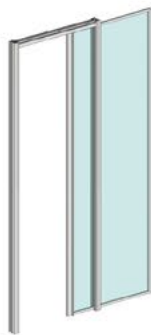

Modulo porta scorrevole vetrata intelaiata a scorrimento interno con spessore 2 cm larghezza 90 cm e altezza variabile da 220 a 270 cm. Vetro laminato 5+PVB+5 mm trasparente o sabbciato. Profili in alluminio anodizzato naturale o verniciati bianchi (RAL 9010) o neri (RAL 9005). Maniglia a tutta altezza integrata nel profilo.

Framed glazed internal sliding door module with a thickness of 2 cm, width 90 cm and variable height from 220 to 270 cm. 5+PVB+5 mm laminated glazing, clear or sandblasted. Profiles in natural anodized aluminum or painted white (RAL 9010) or black (RAL 9005). Integrated vertical full-height handle.

---

Code

**ZYEIGHTYDIV2023**

Vetro trasparente - Clear glass

**ZYEIGHTYDIV2024**

Vetro sabbciato - Sandblasted glass

---

i4MARIANI S.R.L.

VIA S. ANTONIO 102/104 22066 MARIANO COMENSE COMO, ITALY PH +39 031 746204 FAX +39 031 749060  
INFO@I4MARIANI.IT WWW.I4MARIANI.COM

**4MARIANI** | TECH

# FIFTY

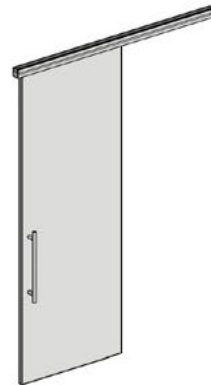
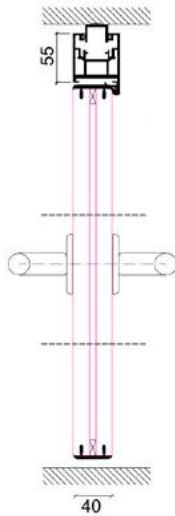
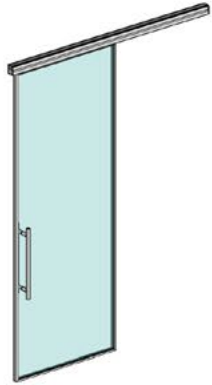
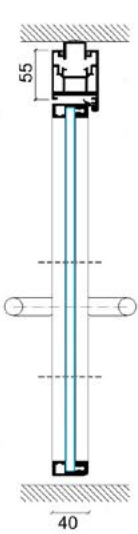
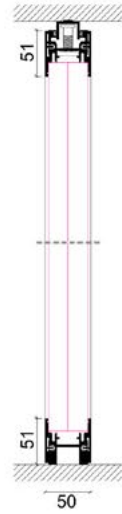
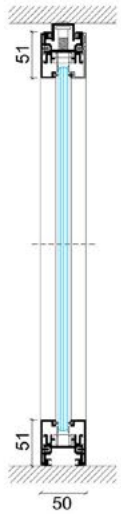
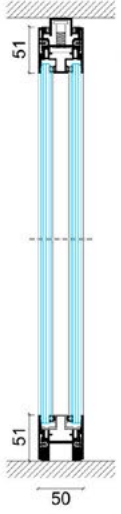

## Caratteristiche tecniche - Technical features

### PANNELLI

Spessore 50 mm

- Singolo o doppio vetro laminato 5+5 mm con interposto film di PVB 0,38 mm. Assorbimento acustico di 33-40 dB.
- Singolo o doppio vetro laminato 5+5 mm con interposto film di PVB 0,50 mm. Assorbimento acustico di 37-42 dB.
- Doppio pannello melaminico 19 mm con assorbimento acustico di 43 dB con inserimento di lana di roccia.

### PANELLING

Thickness 50 mm

- Single or double laminated glazing 5+5 mm with 0,38 mm PVB absorbing film interposed. 33-40 dB sound absorption.
- Single or double laminated glazing 5+5 mm with 0,50 mm PVB absorbing film interposed. 37-42 dB sound absorption.
- Double melamine panel 19 mm with 43 dB sound absorption with mineral wool insertion.

### PORTE

Spessore 40 mm

- Vetro temperato 10 mm.
- Doppio pannello melaminico 19 mm.

### DOORS

Thickness 40 mm

- 10 mm tempered glazing.
- Double melamine panel 19 mm.

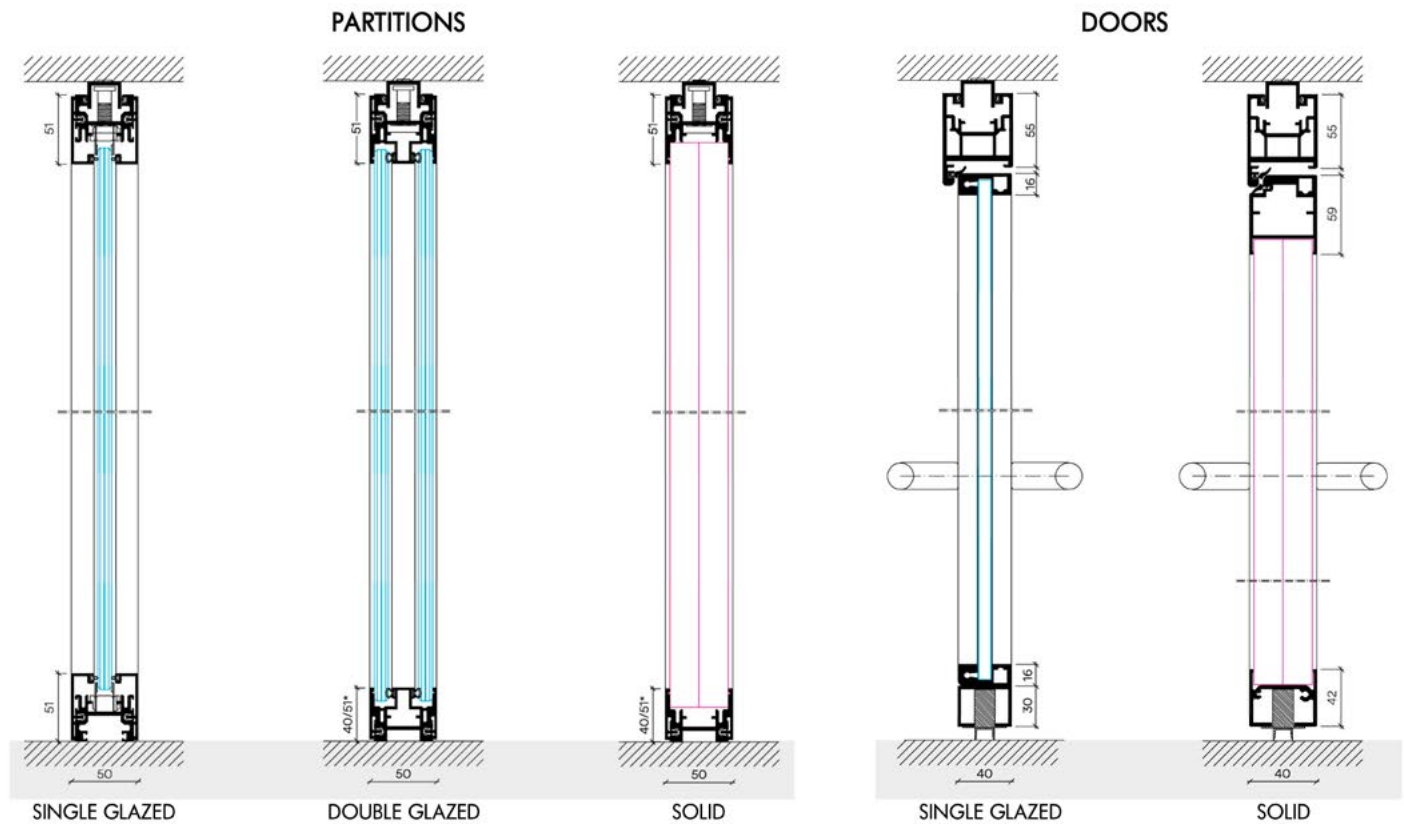

---

## FIFTY - Parete divisoria - Partition wall

---



Modulo di parete divisoria vetrata con spessore 5 cm e altezza variabile da 240 a 320 cm. Doppio vetro laminato 5+PVB+5 mm trasparente o sabbiato. Profili in alluminio anodizzato naturale o verniciati bianchi (RAL 9010) o neri (RAL 9005). Disponibile anche con doppio vetro supersilenziato trasparente con lamina di PVB da 0,5 mm.

5 cm thick glazed partition wall module with variable height from 240 to 320 cm. Double laminated glazing 5+PVB+5 mm clear or sandblasted. Profiles in natural anodized aluminum or painted white (RAL 9010) or black (RAL 9005). Also available with clear super-silenced laminated double glazed with 0.5 mm PVB sheet.

---

**Code****ZYFIFTYDIV3000**

Vetro trasparente - Clear glass

**ZYFIFTYDIV3001**

Vetro sabbiato - Sandblasted glass

**ZYFIFTYDIV3002**

Vetro trasparente supersilenziato - Clear super-silenced glass



Modulo di parete divisoria vetrata con spessore 5 cm e altezza variabile da 240 a 320 cm. Singolo vetro laminato 5+PVB+5 mm trasparente o sabbiato. Profili in alluminio anodizzato naturale o verniciati bianchi (RAL 9010) o neri (RAL 9005). Disponibile anche con singolo vetro supersilenziato trasparente con lamina di PVB da 0,5 mm.

5 cm thick glazed partition wall module with variable height from 240 to 320 cm. Single laminated glazing 5+PVB+5 mm clear or sandblasted. Profiles in natural anodized aluminum or painted white (RAL 9010) or black (RAL 9005). Also available with clear super-silenced laminated single glazed with 0.5 mm PVB sheet.

---

**Code****ZYFIFTYDIV3003**

Vetro trasparente - Clear glass

**ZYFIFTYDIV3004**

Vetro sabbiato - Sandblasted glass

**ZYFIFTYDIV3005**

Vetro trasparente supersilenziato - Clear super-silenced glass



Modulo di parete divisoria cieca con spessore 5 cm e altezza variabile da 240 a 320 cm. Doppio pannello melaminico. Profili in alluminio anodizzato naturale o verniciati bianchi (RAL 9010) o neri (RAL 9005).

5 cm thick solid partition wall module with variable height from 240 to 320 cm. Double melamine coated panel. Profiles in natural anodized aluminum or painted white (RAL 9010) or black (RAL 9005).

---

**Code****ZYFIFTYDIV3006**

---

## FIFTY - Parete divisoria - Partition wall

---



Modulo porta a battente vetrata intelaiata con spessore 4 cm larghezza 90 cm e altezza variabile da 220 a 270 cm. Vetro temperato 10 mm trasparente o sabbaiato. Profili in alluminio anodizzato naturale o verniciati bianchi (RAL 9010) o neri (RAL 9005). Maniglia inclusa.

Hinged framed glazed door module with a thickness of 4 cm, width 90 cm and variable height from 220 to 270 cm. 10 mm tempered glazing, clear or sandblasted. Profiles in natural anodized aluminum or painted white (RAL 9010) or black (RAL 9005). Handle included.

Code

ZYFIFTYDIV3010

Vetro trasparente - Clear glass

ZYFIFTYDIV3011

Vetro sabbaiato - Sandblasted glass

---



Modulo porta a battente cieca intelaiata con spessore 4 cm larghezza 90 cm e altezza variabile da 220 a 270 cm. Doppio pannello melaminico. Profili in alluminio anodizzato naturale o verniciati bianchi (RAL 9010) o neri (RAL 9005). Maniglia inclusa.

Hinged framed solid door module with a thickness of 4 cm, width 90 cm and variable height from 220 to 270 cm. Double melamine coated panel. Profiles in natural anodized aluminum or painted white (RAL 9010) or black (RAL 9005). Handle included.

Code

ZYFIFTYDIV3012

---

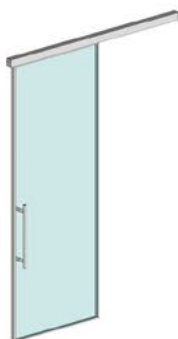

Modulo porta scorrevole vetrata intelaiata con spessore 4 cm larghezza 90 cm e altezza variabile da 220 a 270 cm. Vetro temperato 10 mm trasparente o sabbaiato. Profili in alluminio anodizzato naturale o verniciati bianchi (RAL 9010) o neri (RAL 9005). Maniglia h. 60 cm inclusa.

Framed glazed sliding door module with a thickness of 4 cm, width 90 cm and variable height from 220 to 270 cm. 10 mm tempered glazing, clear or sandblasted. Profiles in natural anodized aluminum or painted white (RAL 9010) or black (RAL 9005). Handle h. 60 cm included.

Code

ZYFIFTYDIV3013

Vetro trasparente - Clear glass

ZYFIFTYDIV3014

Vetro sabbaiato - Sandblasted glass

---

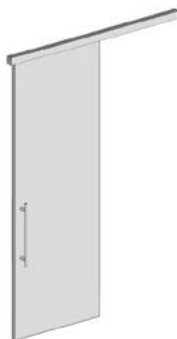

Modulo porta scorrevole cieca intelaiata con spessore 4 cm larghezza 90 cm e altezza variabile da 220 a 270 cm. Doppio pannello melaminico. Profili in alluminio anodizzato naturale o verniciati bianchi (RAL 9010) o neri (RAL 9005). Maniglia h. 60 cm inclusa.

Framed solid sliding door module with a thickness of 4 cm, width 90 cm and variable height from 220 to 270 cm. Double melamine coated panel. Profiles in natural anodized aluminum or painted white (RAL 9010) or black (RAL 9005). Handle h. 60 cm included.

Code

ZYFIFTYDIV3015

---

# TWENTY

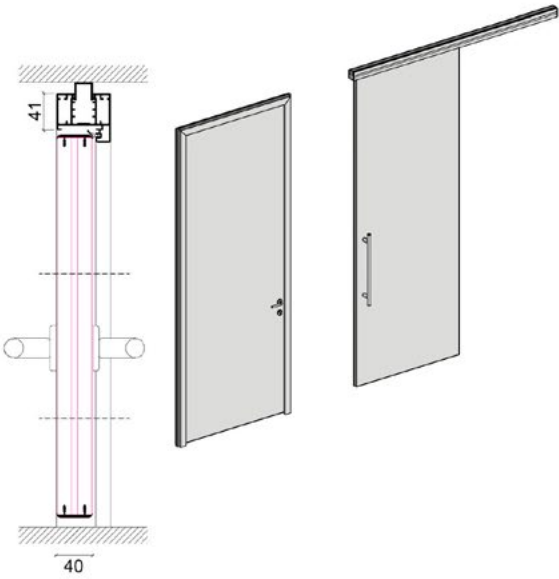
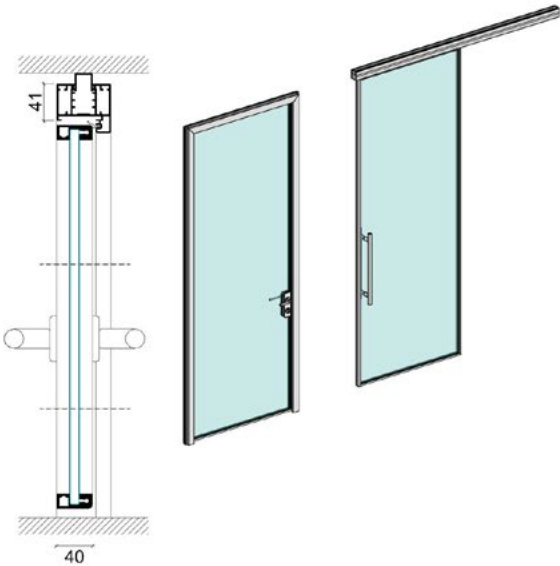
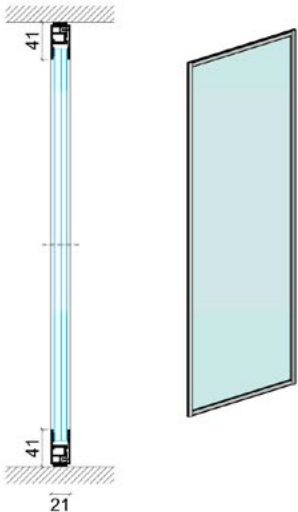

## Caratteristiche tecniche - Technical features

### PANNELLI

Spessore 21 mm

- Singolo vetro laminato 6+8 mm con interposto film di PVB 0,38 mm. Assorbimento acustico di 40 dB.

### PANELLING

Thickness 21 mm

- Single laminated glazing 6+8 mm with 0,38 mm PVB absorbing film interposed. 40 dB sound absorption.

### PORTE

Spessore 40 mm

- Vetro temperato 10 mm.
- Doppio pannello melaminico 19 mm.

### DOORS

Thickness 40 mm

- 10 mm tempered glazing.
- Double melamine panel 19 mm.

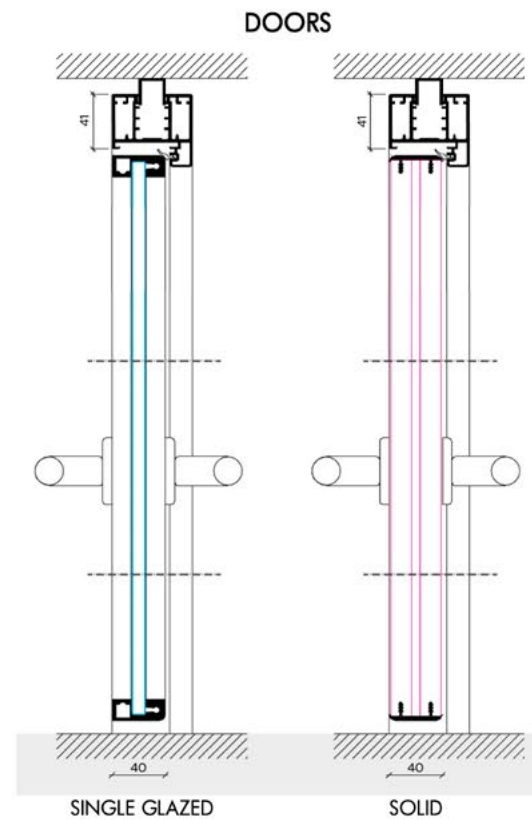
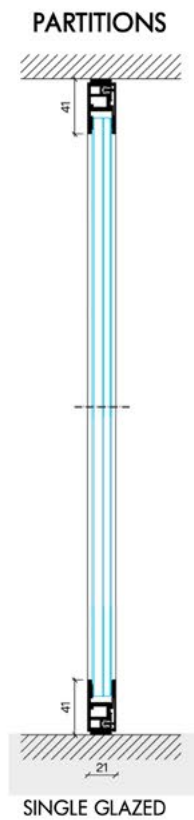

---

## TWENTY - Parete divisoria - Partition wall

---



Modulo di parete divisoria vetrata con spessore 2,1 cm e altezza variabile da 240 a 320 cm. Singolo vetro laminato 6+PVB+8 mm trasparente o sabbciato. Profili in alluminio anodizzato naturale o verniciati bianchi (RAL 9010) o neri (RAL 9005).

2,1 cm thick glazed partition wall module with variable height from 240 to 320 cm. Single laminated glazing 6+PVB+8 mm clear or sandblasted. Profiles in natural anodized aluminum or painted white (RAL 9010) or black (RAL 9005).

---

**Code**

---

**ZYTWENTYDIV4000**

---

Vetro trasparente - Clear glass

---

**ZYTWENTYDIV4001**

---

Vetro sabbciato - Sandblasted glass

---

**ZYTWENTYDIV4002**

---

Vetro trasparente supersilenziato - Clear super-silenced glass

Modulo porta a battente vetrata intelaiata con spessore 4 cm larghezza 90 cm e altezza variabile da 220 a 270 cm. Vetro temperato 10 mm trasparente o sabbciato. Profili in alluminio anodizzato naturale o verniciati bianchi (RAL 9010) o neri (RAL 9005). Maniglia inclusa.

Hinged glazed framed door module with a thickness of 4 cm, width 90 cm and variable height from 220 to 270 cm. 10 mm tempered glazing, clear or sandblasted. Profiles in natural anodized aluminum or painted white (RAL 9010) or black (RAL 9005). Handle included.

---

**Code**

---

**ZYTWENTYDIV4010**

---

Vetro trasparente - Clear glass

---

**ZYTWENTYDIV4011**

---

Vetro sabbciato - Sandblasted glass

Modulo porta a battente cieca intelaiata con spessore 4 cm larghezza 90 cm e altezza variabile da 220 a 270 cm. Doppio pannello melaminico. Profili in alluminio anodizzato naturale o verniciati bianchi (RAL 9010) o neri (RAL 9005). Maniglia inclusa.

Hinged framed solid door module with a thickness of 4 cm, width 90 cm and variable height from 220 to 270 cm. Double melamine coated panel. Profiles in natural anodized aluminum or painted white (RAL 9010) or black (RAL 9005). Handle included.

---

**Code**

---

**ZYTWENTYDIV4012**



---

## TWENTY - Parete divisoria - Partition wall

---

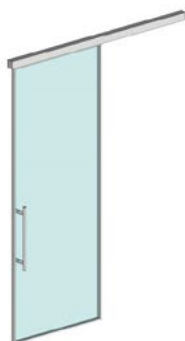

Modulo porta scorrevole vetrata intelaiata con spessore 4 cm larghezza 90 cm e altezza variabile da 220 a 270 cm. Vetro temperato 10 mm trasparente o sabbaiato. Profili in alluminio anodizzato naturale o verniciati bianchi (RAL 9010) o neri (RAL 9005). Maniglia h. 60 cm inclusa.

Framed glazed sliding door module with a thickness of 4 cm, width 90 cm and variable height from 220 to 270 cm. 10 mm tempered glazing, clear or sandblasted. Profiles in natural anodized aluminum or painted white (RAL 9010) or black (RAL 9005). Handle h. 60 cm included.

---

Code

**ZYTWENTYDIV4013**

Vetro trasparente - Clear glass

---

**ZYTWENTYDIV4014**

Vetro sabbaiato - Sandblasted glass

---

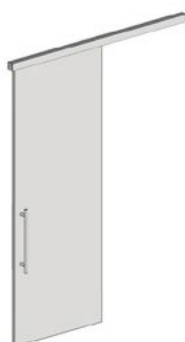

Modulo porta scorrevole cieca intelaiata con spessore 4 cm larghezza 90 cm e altezza variabile da 220 a 270 cm. Doppio pannello melaminico. Profili in alluminio anodizzato naturale o verniciati bianchi (RAL 9010) o neri (RAL 9005). Maniglia h. 60 cm inclusa.

Framed solid sliding door module with a thickness of 4 cm, width 90 cm and variable height from 220 to 270 cm. Double melamine coated panel. Profiles in natural anodized aluminum or painted white (RAL 9010) or black (RAL 9005). Handle h. 60 cm included.

---

Code

**ZYTWENTYDIV4015**

---

i4MARIANI S.R.L.

VIA S. ANTONIO 102/104 22066 MARIANO COMENSE COMO, ITALY PH +39 031 746204 FAX +39 031 749060  
INFO@I4MARIANI.IT WWW.I4MARIANI.COM

**4MARIANI** | TECH

## Caratteristiche e finiture disponibili per TUTTE le pareti divisorie - Features and finishes available for ALL partition walls

La struttura di tutte le tipologie di parete divisoria è costituita da profili di alluminio estruso con 4 spessori diversi e disponibile in finitura anodizzata naturale oppure verniciato in colore bianco (RAL 9010) o nero (RAL 9005). Essa è costituita da una traversa superiore ed una inferiore che vengono fissate a soffitto e pavimento rispettivamente, oltre a dei montanti verticali che assicurano la stabilità della struttura stessa. Delle guarnizioni in morbido PVC sono poste lungo tutto il perimetro della struttura, per garantire la tenuta acustica.

I pannelli di chiusura delle strutture sono disponibili in due tipologie:

- pannello melaminico singolo o doppio;
- vetro laminato con interposto un film fonoassorbente in PVB o vetro temperato. Disponibili singoli o doppi e con finitura trasparente oppure sabbiata.

In base al tipo e numero di pannelli, il potere fonoassorbente della parete divisoria cambia in maniera sensibile.

La stessa tipologia di pannellatura è disponibile anche per i diversi moduli porta a battente o scorrevole.

I prezzi di seguito riportati sono in Euro/mq. e sono indicativi. Per una valutazione corretta e definitiva sarà necessario uno sviluppo dimensionale e economico del progetto da parte del nostro ufficio tecnico.

The structure of all types of dividing wall is made up of extruded aluminum profiles with 4 different thicknesses and available in natural anodized finish or painted in white (RAL 9010) or black (RAL 9005). It consists of an upper and a lower crossbar which are fixed to the ceiling and floor respectively, as well as vertical uprights which ensure the stability of the structure itself. Soft PVC gaskets are placed along the entire perimeter of the structure, to ensure acoustic sealing.

The closing panels of the structures are available in two types:

- single or double melamine panel;
- laminated glass with a PVB sound-absorbing film interposed or tempered glass. Available single or double and with clear or sandblasted finish.

Depending on the type and number of panels, the sound-absorbing power of the partition wall changes significantly.

The same type of paneling is also available for the different swing or sliding door modules.

The prices listed below are in Euro/sqm. and are indicative. For a correct and definitive evaluation it will be necessary a dimensional and economic development of the project by our technical department.

### Pannelli in melaminico - Melamine panels



Lino FA41



Noce Chiaro LM01



Rovere Grigio LG18



Rovere Bianco LK84



Noce Canaletto LN83



Rovere Spessart LM76



Rovere Magister LK97



Ash S001



Bianco B007

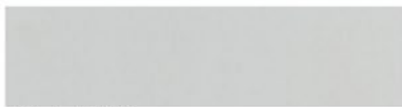

Grigio U110

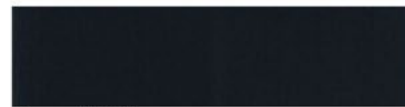

Nero U129



Avorio U100



Grafite UB08

## Vetro - Glass

---



Vetro trasparente  
Clear glass



Vetro satinato  
Sandblasted glass

## Profili - Profiles

---



Alluminio anodizzato naturale  
Natural anodized aluminum



Bianco (RAL 9010)  
White (RAL 9010)



Nero (RAL 9005)  
White (RAL 9005)

## Maniglie disponibili per moduli porta a battente - Available handles for swing door modules

---



A forma di "C" arrotondata  
in inox satinato  
Rounded "C" shaped stainless steel

A forma di "L" arrotondata  
in inox satinato  
Rounded "L" shaped stainless steel

A forma di "L" squadrata  
in inox satinato  
Squared "L" shaped stainless steel

